

26 689 243 1 TEMPESTA SYSTEM 250 CUBE SISTEMA DE DUCHE COM TERMOSTÁTICA

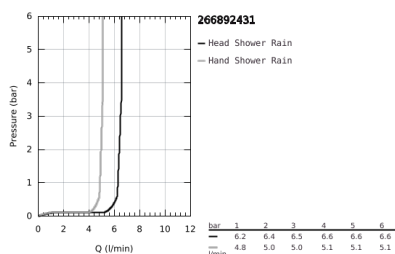
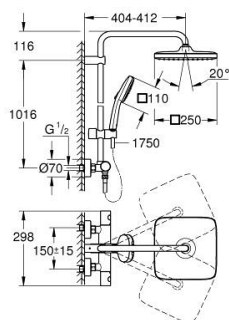

DESCRIÇÃO DO PRODUTO (1/2)

- Colour: matte black
- Composto por:
- Braço de chuveiro 390 mm
- Termostática
- Permite alternar entre:
- Chuveiro de parede Tempesta 250 Cube
- Jato:
- Rain
- head shower with black rear cover
- Rótula orientável
- Ângulo de rotação $\pm 10^\circ$
- hand shower Tempesta Cube 110
- 2 jatos:
- Rain, Jet
- Com suporte ajustável em altura
- shower hose 1750 mm 1/2" x 1/2" (28 388)
- maximum flow rate (at 3 bar): 7.3 l/min
- GROHE Water Saving para menor consumo e jato perfeito
- Cartucho compacto GROHE TurboStat com termoelemento em cera
- Limitador de temperatura GROHE SafeStop 38°C
- GROHE SafeStop Plus (opcional) limitador de temperatura a 43°C
- GROHE SmartSwitch - facilidade em alternar o seu jato preferido
- Jato perfeito com o GROHE DreamSpray
- ShockProof anel de silicone à prova de choque que previne danos causados pela queda do chuveiro

Pure Freude
an Wasser



26 689 243 1 **TEMPESTA SYSTEM 250 CUBE SISTEMA DE DUCHE COM TERMOSTÁTICA**

DESCRIÇÃO DO PRODUTO (2/2)

- Acabamento GROHE Long-Life
- Sistema anticalcário SpeedClean
- Guia de água interior para longa duração
- Sistema de rotação livre da bicha do chuveiro TwistStop
- Adequado para utilização com esquentadores a partir de 18 kWh
- Caudal mínimo recomendado 7 l/min.
- Upgrade opcional: saboneteira GROHE EasyReach (26 362)
- Edição Profissional

Technical drawing of the shower assembly. The main drawing shows the shower head (1) connected to the shower arm (2) via the shower hose (3). The shower arm is mounted to the wall bracket (4) using the mounting bracket (5). The shower head is connected to the shower arm via the shower head connector (6). The shower head is also connected to the shower arm via the shower head connector (7). The shower head is also connected to the shower arm via the shower head connector (8). The shower head is also connected to the shower arm via the shower head connector (9). The shower head is also connected to the shower arm via the shower head connector (10). The shower head is also connected to the shower arm via the shower head connector (11). The shower head is also connected to the shower arm via the shower head connector (12). The shower head is also connected to the shower arm via the shower head connector (13). The shower head is also connected to the shower arm via the shower head connector (14). The shower head is also connected to the shower arm via the shower head connector (15). The shower head is also connected to the shower arm via the shower head connector (16). The shower head is also connected to the shower arm via the shower head connector (17). The shower head is also connected to the shower arm via the shower head connector (18). The shower head is also connected to the shower arm via the shower head connector (19). The shower head is also connected to the shower arm via the shower head connector (20).

Exploded views and details:

- Detail 16:** X=150mm, T=9, X=150mm. Shows a cross-section of the shower head connector.
- Detail 17:** 2000mm. Shows a long shower hose.
- Detail 18:** 15. Shows a shower head connector.
- Detail 19:** 3. Shows a shower head connector.
- Detail 20:** 15. Shows a shower head connector.